

# **EXHIBIT A**

ALTO LITIGATION, PC  
Ellen London (Bar No. 325580)  
ellen@altolit.com  
Bess Ibtisam Hanish (Bar No. 325938)  
bess@altolit.com  
4 Embarcadero Center, Suite 1400  
San Francisco, CA 94111  
Telephone: (415) 779-2586  
Facsimile: (415) 306-8744

THE STOUT FIRM, P.C.  
Thomas D. Stout (Bar No. 241348)  
tstout@stoutfirm.com  
317 Washington Street, Suite 170  
Oakland, CA 94607  
Telephone: (415) 862-8485  
Facsimile: (415) 862-8487

Attorneys for Interested Party  
CN UTILITY CONSULTING, INC.

**UNITED STATES DISTRICT COURT**  
**FOR THE NORTHERN DISTRICT OF CALIFORNIA**  
**SAN FRANCISCO DIVISION**

UNITED STATES OF AMERICA,  
  
Plaintiff,  
  
v.  
  
PACIFIC GAS AND ELECTRIC  
COMPANY,  
  
Defendant.

No. CR 14-00175-WHA

**DECLARATION OF [REDACTED]  
[REDACTED] IN RESPONSE TO THE  
COURT'S FEBRUARY 5, 2021 ORDER**

I, [REDACTED], declare as follows:

1. I am currently a forester with Clear Path Utility Solutions LLC, a company based in Auburn, California. I am an independent contractor.
2. I have reviewed the Court's order in this matter, dated February 5, 2021, Docket No. 1297.
3. I have reviewed the photograph at Docket No. 1250-4 and page 11 of the Court's order dated December 29, 2020, in which the Court specifically identifies a gray pine (the "Gray Pine") shown at Docket No. 1250-4.

4. Based on having reviewed the photograph and description described in the order, I believe I understand to which tree the Court is referring in the February 5, 2021 Order.

5. I submit this declaration in response to the Court's February 5, 2021 Order.

## **I. POSITION AND EMPLOYER**

6. Between approximately August 2014 and November 2018, I was employed by CN Utility Consulting, Inc. ("CNUC"). I began as a Consulting Utility Forester ("CUF") II. In October 2018, I was promoted to Lead Field CUF.

7. At the time I worked for CNUC, CNUC provided vegetation management contracting services to Pacific Gas and Electric Company ("PG&E").

## **II. QUALIFICATIONS AND LICENSE<sup>1</sup>**

8. I received an Associate Degree in forestry in 1998.

9. In late 2016 or early 2017, I was certified as an Arborist by the International Society of Arboriculture ("ISA"). To be eligible for ISA certification, an applicant must have at least three years of full-time, eligible, practical work experience in arboriculture or a degree in the field of arboriculture, horticulture, landscape architecture, or forestry, and pass a rigorous examination.

10. After receiving my forestry degree in 1998, I spent six months in each of the next three years evaluating forests for the U.S. Forest Service.

11. From 2007-2014, I worked for the Western Shasta Resource Conservation District. While working there, I was responsible for cutting fuel breaks, creating defensible space, and removing tree hazards. I also worked on conservation projects such as erosion control and streambed restoration. I became familiar with Zogg Mine Road during this employment, as I was responsible for creating a large fuel break along Zogg Mine Road.

12. I began working for CNUC in August 2014. When I began working there, I received training in the field, including along Route 50 of the Girvan Circuit and Zogg Mine Road.

---

<sup>1</sup> This is not a comprehensive list of all my work experience; I have only included work experience relevant to vegetation management.

13. When I began working for CNUC, I also was given a binder containing PG&E vegetation management policies and procedures, as well as other company procedures, that I reviewed and have kept with me at all times while performing pre-inspection work.

14. I am familiar with the requirements of General Order 95 and Rule 35, as well as the Public Resource Code Section 4293 Power Line Fire Prevention Field Guide. I received both initial and recurring training on these standards throughout my time at CNUC.

15. I have extensive experience with wildfire cleanup and recovery, having worked in such capacity after the following fires:

- a. The Valley Fire (Lake County, 2015)
- b. The Ponderosa Fire (Butte County, 2017)
- c. The LaPorte Fire (Butte County, 2017–2018)
- d. The North Bay Fires (Napa County, 2017)
- e. The North Bay Fires (Butte County, 2017)
- f. The Honey Run Fire (Butte County, 2017)
- g. The North Complex Fire (Plumas and Butte Counties, 2020)
- h. The Camp Fire (Butte County, 2018)

16. During my time at CNUC, I was responsible for the wildfire cleanup and recovery work discussed above as well as for conducting routine inspections.

17. I received positive performance reviews from my supervisors during my time at CNUC and was assigned to train new hires.

18. Since leaving CNUC in November 2018, I have worked as a forester at two additional vegetation management companies, including my current employer.

### **III. DATE OF GRAY PINE DETERMINATION**

19. In October 2018, I was assigned to conduct a routine patrol of Route 50 of the Girvan 1101 Circuit. Zogg Mine Road was within the area to which I was assigned.

20. I was familiar with this route both from my work before being hired at CNUC and because I had conducted routine patrols on Route 50 in 2016 and 2017.

21. I do not specifically remember inspecting the Gray Pine identified by the Court. Based on my review of inspection records I generated in the course of the October 2018 routine patrol of Route 50, however, I know that I would have been inspecting the portion of the Girvan Circuit that included the Gray Pine on October 12, 2018. A copy of the relevant record generated on October 12, 2018, is attached hereto as Exhibit 1. Based on my review of these records, I believe I would have inspected the Gray Pine on approximately October 12, 2018.

#### IV. INVESTIGATION OF GRAY PINE

22. As stated above, I do not specifically remember my investigation of the Gray Pine.

23. Based on my review of the photograph at Docket No. 1250-4 and my experience and usual practice in inspecting Route 50, I believe that I would have looked down both sides of the power lines for the segment closest to the Gray Pine to identify any trees encroaching too close to the power lines or that I expected would encroach into that space over the next year. If I saw any such trees, I would have marked them for trimming.

24. Next, I would have walked the length of the segment from one pole to the next, looking carefully at the surrounding trees for any signs of dead or dying trees. Had I seen any dead or dying trees near the footprint of the power lines, I would have marked them for removal.

25. Based on my review of the Gray Pine in the photograph at Docket No. 1250-4, I believe that the Gray Pine was healthy as of the time the picture was taken. It has a green canopy, indicating that the tree is able to take in nutrients through its roots and distribute them to its canopy. I do not see any indication of disease or other evidence suggesting that it was a tree that should be marked for removal in the photograph.

26. Although I do not specifically remember doing so, based on my practice and my experience inspecting Route 50, I believe that at the time I conducted the October 2018 routine inspection, I would have walked around the Gray Pine and inspected it from all sides for fire damage or disease. In so doing, I likely would have come within ten feet of the Gray Pine.

27. During the October 2018 routine inspection generally, I was aware that the area had been affected by the Carr Fire recently, and I was paying close attention to whether any tree showed signs of fire damage.

1 **V. PHOTOGRAPHS, NOTES, OR VIDEOS**

2 28. If I had taken photographs or videos while conducting the October 2018 routine  
3 inspection of Route 50, I would have done so with my smartphone. I have reviewed the contents  
4 of my smartphone and confirmed that I have no pictures or videos of the Gray Pine in my  
5 possession.

6 29. My practice when conducting routine patrols is to input all notes and observations  
7 into PG&E's Getac Preload on a tablet or smartphone I carried with me during my patrol. Those  
8 notes and observations are sent to a database maintained by PG&E. I do not keep or maintain  
9 separate notes.

10 **VI. REPORTS**

11 30. As discussed above at paragraph 29, during a patrol I would input all notes and  
12 observations into PG&E's Getac system,. I did not create any reports regarding specific trees  
13 separate from that reporting system. Upon completion of the October 2018 routine inspection, I  
14 completed, signed, and submitted a preliminary inspection checklist, a true and correct copy of  
15 which is attached hereto as Exhibit 2.

16 31. I believe that the record attached as Exhibit 1 to this declaration is the report I  
17 would have generated through Getac on the date I inspected the portion of Route 50 that includes  
18 the Gray Pine. The report does not mention or refer to the Gray Pine.

19 **VII. REASONS RE: NOT MARKING GRAY PINE**

20 32. As discussed above, I do not specifically remember the Gray Pine.

21 33. When conducting routine patrols, it was not my practice to submit notes or reports  
22 concerning healthy trees that did not require work. Based on the absence of any work orders,  
23 notes, or reports concerning the Gray Pine, I believe that at the time I would have inspected it in  
24 October 2018, I did not expect it to pose a threat to the power line in the next year.

25 34. My review of Exhibit D to Docket No. 1250-4 is consistent with this. In this  
26 picture, as discussed above, the Gray Pine appears to be a healthy tree that was in compliance with  
27 all vegetation management standards governing its proximity to the power lines.  
28

1 **VIII. KNOWLEDGE REGARDING GRAY PINE**

2 35. As discussed above, I do not specifically remember the Gray Pine.

3 36. Accordingly, I cannot say whether, at the time I inspected the Gray Pine, I was  
4 aware of any pre-existing damage to the tree. Had I been aware of pre-existing damage to the tree,  
5 I likely would have conducted a closer inspection of the tree. Not all damage is fatal to a tree or  
6 compromises its health, however, so mere awareness of pre-existing damage would have been  
7 insufficient to cause me to mark it for trimming or removal without knowing the nature or extent  
8 of the pre-existing damage. As noted above, during the October 2018 routine inspection generally,  
9 I was aware that the area had been affected by the Carr Fire recently, and I was paying close  
10 attention to whether any tree showed signs of fire damage.

11 37. Based on my practices at the time I conducted the 2018 routine inspection, I believe  
12 I would have noticed the lean of the tree and the species of the tree. Having reviewed the  
13 photograph at Docket No. 1250-4, I do not regard the lean of the Gray Pine as indicative of a  
14 threat to the power line likely to arise in the subsequent year. Based on my experience, I know  
15 that before the Zogg Fire there were countless healthy trees along Route 50 that exhibit a similar  
16 or more drastic lean toward power lines that would be affected by a fall. That, however, is not a  
17 basis to remove the tree under applicable vegetation management standards absent concerns about  
18 the health of the tree or out-of-compliance proximity to a power line.

19 **IX. DIRECTION OF LEAN AND POTENTIAL FALL**

20 38. As discussed above, I do not specifically remember the Gray Pine.

21 39. As also discussed above, based on my review of the photograph at Docket No.  
22 1250-4, I believe it would have been obvious to me at the time I conducted the October 2018  
23 routine patrol that if the Gray Pine fell in the direction of its lean, it would fall upon the power  
24 line.

25 40. Based on my experience and my practices when conducting the October 2018  
26 Routine Patrol, I believe this observation would have prompted me to conduct a closer inspection  
27 of the tree, including walking around it from all sides within approximately ten feet.  
28

41. Based on my experience and my practices when conducting the October 2018 Routine Patrol, I believe this observation would have prompted me to err on the side of caution when deciding whether to mark the tree for removal. That I did not mark the Gray Pine for removal leads me to believe I was confident it did not present a threat to the power lines within the year following my inspection.

**X. OTHER PERTINENT INFORMATION**

42. The Carr Fire burned in July and August 2018 in Shasta and Trinity Counties, including in parts of Shasta County that would later be affected by the Zogg Fire, including sections of Route 50 of the Girvan 1101 circuit.

43. After the Carr Fire, PG&E contracted with, among other companies, Mountain G Enterprises Inc. ("MGE") to perform post-fire cleanup work. MGE was responsible for performing and overseeing post-Carr Fire work in the area surrounding the Gray Pine.

44. After the Zogg Fire, I was hired by MGE to go to Zogg Mine Road in November 2020 to review trees in the area around the Gray Pine. At this time, I was not employed by CNUC and had not been so employed for nearly two years. My understanding, based both on my experience performing the October 2018 routine patrol and in later discussions with MGE representatives, was that during post-Carr Fire work, certain trees had been marked for trimming or removal which had not been trimmed or removed. MGE retained me to investigate and determine whether any trees that fell on the power lines near the location where CAL FIRE was conducting its investigation of the Zogg Fire were trees that had been marked for work but not ultimately worked. I was hired by MGE due to my familiarity with this area.

45. MGE provided me with the location data from the Collector Application for trees it had marked for work during the post-Carr Fire work.

46. Using the latitude/longitude data from MGE, I visited the site where CAL FIRE was conducting its investigation in November 2020. I inspected the site and observed the Gray Pine.



1           47.     Based on the data that I had from the Collector Application, I identified two trees  
2 that had originally been marked for work that were part of a cluster of four gray pines in the  
3 relevant area.

4           48.     While at the site of CAL FIRE's investigation, I observed that the tree that CAL  
5 FIRE cut down was an R2, meaning a diameter at breast height ("DBH") of at least twelve and  
6 less than 24 inches, and the other tree—which had fallen on the line—was an R3, meaning a DBH  
7 of at least 24 and less than 36 inches. The location of these two trees appeared to me consistent  
8 with the coordinates for trees that had been marked for work during the post-Carr Fire cleanup  
9 work that ultimately had not been worked. Therefore, in my view, the odds are that the Gray Pine  
10 was among the trees marked for work, although I cannot be certain of that.

11          I declare under penalty of perjury under the laws of the United States that the foregoing is true  
12 and correct.

13  
14          DATED: February 12, 2021

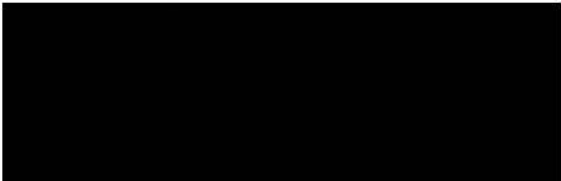

# **EXHIBIT 1**

**Cust.Inf.** **MAP** **History****Inspection Record Detail**

|   |  |                       |                             |                           |                             |  |                                     |                         |                               |   |   |   |   |
|---|--|-----------------------|-----------------------------|---------------------------|-----------------------------|--|-------------------------------------|-------------------------|-------------------------------|---|---|---|---|
| <b>A</b>  |  |                       |                             | <b>City:</b><br>IGO       | <b>County:</b><br>SH        | <b>Directions:</b><br>S/ON PLACER>W/ON SOUTH FORK RD>N/ON ZOGG MINE; N/OF LARRY HORSE LN |                                     |                         |                               | <b>Inspector / Company:</b><br>[REDACTED] - CNU |   |   |   |
| <b>Division:</b><br>North Valley  | <b>Circuit:</b><br>(0103401101)<br>GIRVAN 1101 | <b>SSD #:</b><br>4855 | <b>SSD Rte #:</b><br>50     | <b>Routing #:</b><br>1370 | <b>(none):</b>              |  | <b>Area:</b><br>P-25                | <b>SRA:</b><br>Yes      | <b>Alerts:</b><br>AX NF PI    |   |   |   |   |
| <b>Insp Date / Time:</b><br>10/12/2018 9:24:39 AM   |  | <b>Tag Type:</b>      | <b>Tag Number:</b>          | <b>Line Name:</b>         |                             |  | <b>Pole Num:</b>                    | <b>Quad Map:</b><br>C-6 | <b>Removal #:</b><br>3872742  | <b>Customer Name/Phone:</b><br>[REDACTED]       |   |   |   |
| <b>Comment:</b><br>P58 TP ON DRWY @ 1ST DRWY ENT PAST 8455 ADD FLGD GT P59 1S/W/OF P58 TP ABOVE ZOGG MINE RD CUST WANTS TO KNOW WHO IS ON PROPERTY.MUST CALL TO HAVE GT OPENED. |  |                       |                             |                           |                             |  |                                     |                         |                               |   |   |   |   |
|   |  |                       |                             |                           |                             |  |                                     |                         |                               | <b>  Audit  </b>                                | <b>Last Edit:</b> 10/12/2018 12:12:01 PM by: [REDACTED] |   |   |
| <b>Tree Number</b><br><br>1   | <b>Tree Species:</b><br>Live Oak               | <b>Crew:</b><br>CA    | <b>Priority:</b><br>Routine | <b>TGR:</b><br>No         | <b>Owned By:</b><br>Private | <b>Height DBH</b><br>45 9  | <b>Clearance Prox:</b><br>Inside    | <b>Cycle:</b>           | <b>Qty:</b><br>1              | <b>Trim Type:</b><br>FS-R1A+Trt                 | <b>Account:</b><br>M                                    | <b>Wire Conditions:</b>                                   | <b>Insp Date:</b><br>10/12/2018 [REDACTED] AM |
| <b>Comment:</b><br>@ P59; DEAD+ROT, UP HILL   |  |                       |                             |                           |                             | <b>Notification:</b><br>OK   | <b>Work Request:</b><br>C1NV1001518 |                         | <b>WC Date:</b><br>2/15/2019  | <b>WC Qty:</b><br>1                             | <b>WC Trim:</b><br>F1D                                  | <b>Completed By:</b><br>[REDACTED]                        | <b>Invoice:</b><br>XX (104)                   |
| <b>Lat/Long:</b><br>40.538677, -122.562037 <a href="#">Google Map!</a>  |  |                       |                             |                           |                             | <b>External TreeID:</b><br>W122562037N40538677   |                                     |                         |                               |   | <b>  Audit  </b>  | <b>Last Edit:</b><br>10/12/2018 by: [REDACTED]            |   |
| <b>Rx Comment:</b>  |  |                       |                             |                           |                             |  |                                     |                         |                               |   |   |   |   |
| <b>Tree Number</b><br><br>2   | <b>Tree Species:</b><br>Gray Pine              | <b>Crew:</b><br>CA    | <b>Priority:</b><br>Routine | <b>TGR:</b><br>No         | <b>Owned By:</b><br>Private | <b>Height DBH</b><br>45 8  | <b>Clearance Prox:</b><br>99 Inside | <b>Cycle:</b>           | <b>Qty:</b><br>1              | <b>Trim Type:</b><br>FP-Rmv1 A                  | <b>Account:</b><br>M                                    | <b>Wire Conditions:</b>                                   | <b>Insp Date:</b><br>10/12/2018 9:15:53 AM    |
| <b>Comment:</b><br>@ P59; DEAD, UP HILL   |  |                       |                             |                           |                             | <b>Notification:</b><br>OK   | <b>Work Request:</b><br>C1NV1001518 |                         | <b>WC Date:</b><br>2/15/2019  | <b>WC Qty:</b><br>1                             | <b>WC Trim:</b><br>F1B                                  | <b>Completed By:</b><br>[REDACTED]                        | <b>Invoice:</b><br>XX (104)                   |
| <b>Lat/Long:</b><br>40.53868, -122.562035 <a href="#">Google Map!</a>   |  |                       |                             |                           |                             | <b>External TreeID:</b><br>W122562035N40538680   |                                     |                         |                               |   | <b>  Audit  </b>  | <b>Last Edit:</b><br>10/12/2018 by: [REDACTED]            |   |
| <b>Rx Comment:</b>  |  |                       |                             |                           |                             |  |                                     |                         |                               |   |   |   |   |
| <b>Tree Number</b><br><br>3   | <b>Tree Species:</b><br>Live Oak               | <b>Crew:</b><br>CA    | <b>Priority:</b><br>Routine | <b>TGR:</b><br>No         | <b>Owned By:</b><br>Private | <b>Height DBH</b><br>25 14   | <b>Clearance Prox:</b><br>16 Inside | <b>Cycle:</b><br>Rtn    | <b>Qty:</b><br>1              | <b>Trim Type:</b><br>Slope                      | <b>Account:</b><br>M                                    | <b>Wire Conditions:</b>                                   | <b>Insp Date:</b><br>11/2/2017 2:00 PM        |
| <b>Comment:</b><br>.1S/W/OF P59   |  |                       |                             |                           |                             | <b>Notification:</b>   | <b>Work Request:</b><br>SHNV1024545 |                         | <b>WC Date:</b><br>12/20/2017 | <b>WC Qty:</b><br>1                             | <b>WC Trim:</b><br>SL                                   | <b>Completed By:</b><br>[REDACTED]                        | <b>Invoice:</b><br>TR (104)                   |
| <b>Lat/Long:</b><br>40.538212, -122.561195 <a href="#">Google Map!</a>  |  |                       |                             |                           |                             | <b>External TreeID:</b><br>W122561195N40538212   |                                     |                         |                               |   | <b>  Audit  </b>  | <b>Last Edit:</b><br>10/12/2018 9:24:38 AM by: [REDACTED] |   |
| <b>Rx Comment:</b>  |  |                       |                             |                           |                             |  |                                     |                         |                               |   |   |   |   |
| <b>Tree Number</b><br><br>4   | <b>Tree Species:</b><br>Gray Pine              | <b>Crew:</b><br>CA    | <b>Priority:</b><br>Routine | <b>TGR:</b><br>No         | <b>Owned By:</b><br>Private | <b>Height DBH</b><br>85 24   | <b>Clearance Prox:</b><br>15 Inside | <b>Cycle:</b><br>Rtn    | <b>Qty:</b><br>1              | <b>Trim Type:</b><br>FP-Ov A                    | <b>Account:</b><br>M                                    | <b>Wire Conditions:</b>                                   | <b>Insp Date:</b><br>10/12/2018 9:20:45 AM    |
| <b>Comment:</b><br>.3S/W/OF P59; REMOVE DEAD LIMB   |  |                       |                             |                           |                             | <b>Notification:</b><br>OK   | <b>Work Request:</b><br>C1NV1001518 |                         | <b>WC Date:</b><br>2/15/2019  | <b>WC Qty:</b><br>1                             | <b>WC Trim:</b><br>FOA                                  | <b>Completed By:</b><br>[REDACTED]                        | <b>Invoice:</b><br>XX (104)                   |
| <b>Lat/Long:</b><br>40.538678, -122.56236 <a href="#">Google Map!</a>   |  |                       |                             |                           |                             | <b>External TreeID:</b><br>W122562360N40538678   |                                     |                         |                               |   | <b>  Audit  </b>  | <b>Last Edit:</b><br>10/12/2018 by: [REDACTED]            |   |
| <b>Rx Comment:</b>  |  |                       |                             |                           |                             |  |                                     |                         |                               |   |   |   |   |
| <b>Tree Number</b><br><br>5   | <b>Tree Species:</b><br>Gray Pine              | <b>Crew:</b><br>CA    | <b>Priority:</b><br>No Trim | <b>TGR:</b><br>No         | <b>Owned By:</b><br>Private | <b>Height DBH</b><br>80 23   | <b>Clearance Prox:</b><br>0 Inside  | <b>Cycle:</b><br>Rtn    | <b>Qty:</b><br>1              | <b>Trim Type:</b><br>Side                       | <b>Account:</b><br>M                                    | <b>Wire Conditions:</b>                                   | <b>Insp Date:</b><br>6/25/2012 1:00 PM        |
| <b>Comment:</b><br>.3 & .4S/W/O P59   |  |                       |                             |                           |                             | <b>Notification:</b>   | <b>Work Request:</b>                |                         | <b>WC Date:</b>               | <b>WC Qty:</b>                                  | <b>WC Trim:</b>   | <b>Completed By:</b>                                      | <b>Invoice:</b><br>Not Worked                 |
| <b>Lat/Long:</b>  |  |                       |                             |                           |                             | <b>External TreeID:</b>  |                                     |                         |                               |   | <b>  Audit  </b>  | <b>Last Edit:</b><br>10/12/2018 9:24:37 AM by: [REDACTED] |   |
| <b>Rx Comment:</b>  |  |                       |                             |                           |                             |  |                                     |                         |                               |   |   |   |   |
| <b>Tree Number</b><br><br>6   | <b>Tree Species:</b><br>Live Oak               | <b>Crew:</b><br>CA    | <b>Priority:</b><br>Routine | <b>TGR:</b><br>No         | <b>Owned By:</b><br>Private | <b>Height DBH</b><br>40 13   | <b>Clearance Prox:</b><br>12 Inside | <b>Cycle:</b><br>Rtn    | <b>Qty:</b><br>1              | <b>Trim Type:</b><br>Side                       | <b>Account:</b><br>M                                    | <b>Wire Conditions:</b>                                   | <b>Insp Date:</b><br>6/25/2012 1:40:01 PM     |
| <b>Comment:</b><br>.9S/W/O P59  |  |                       |                             |                           |                             | <b>Notification:</b>   | <b>Work Request:</b><br>SHNV1018602 |                         | <b>WC Date:</b><br>8/7/2012   | <b>WC Qty:</b><br>1                             | <b>WC Trim:</b><br>SD                                   | <b>Completed By:</b><br>[REDACTED]                        | <b>Invoice:</b><br>TR (104)                   |
| <b>Lat/Long:</b>  |  |                       |                             |                           |                             | <b>External TreeID:</b>  |                                     |                         |                               |   | <b>  Audit  </b>  | <b>Last Edit:</b><br>10/12/2018 9:24:37 AM by: [REDACTED] |   |

Rx Comment:

# **EXHIBIT 2**



## North Valley Distribution Post PI Checklist

Circuit: Girvan 1101 <sup>2099 mine</sup> Route # 50 Packet # \_\_\_\_\_ Inspector [REDACTED]

- ☒ HIGHLIGHT, SIGN, AND DATE COMPLETED ROUTE ON INDEX MAP AND PUT IN CIRCUIT FOLDER
- ☒ HIGHLIGHT, SIGN, AND DATE FIELD MAP AND STAPLED TO THIS FORM & PUT IN SCUF'S BOX
- ☒ ANY NEW MWS TREES BROUGHT TO SUPERVISORS ATTENTION
- ☒ ANY OLD PAPER MWS FORMS UPDATED AND BROUGHT TO SCUF'S ATTENTION
- ☒ ALL REMOVAL FROMS ACCOUNTED FOR
- ☒ NO TREES CAN CONTACT LINES WITHIN 4 WEEKS
- ☒ NO FPT TREES REQUIRE IMMEDIATE ATTENTION (TALK TO SCUF ABOUT ANY R3 & R4 FP WORK)
- ☒ VERIFY THAT ALL IDLE LINE IS IDENTIFIED ON BOTH MASTER AND INDEX MAPS AND IDLE FORM IS UPDATED; PICTURES TAKEN, AND SECTION OF THE MAP IS INCLUDED IN THE CIRCUIT FOLDER

N/A PRIVATE LINE INTERFACE FORMS UPDATED AND IN CIRCUIT FOLDER

- ☒ ANY CUSTOMER ISSUES BROUGHT TO SCUF'S ATTENTION AND UPDATED IN CIRCUIT FOLDER
- ☒ CUSTOMER POSTCARDS FILLED OUT AND GIVEN TO DMS
- ☒ PACKET CHECKED BACK INTO VMD FROM THE GETAC

N/A USFS NTW NUMBER

N/A BLM NTW NUMBER

N/A CALTRANS NTW NUMBER

N/A OTHER AGENCY NTW NUMBER (PLEASE SPECIFY AGENCY) N/A

WILL THERE BE AN INCREASE OR DECREASE IN UNITS NEXT YEAR? Decrease

UNITS THIS YEAR: 280; ESTIMATED UNITS NEXT YEAR 200

SIGNATURE AND DATE: [REDACTED] 10/26/18



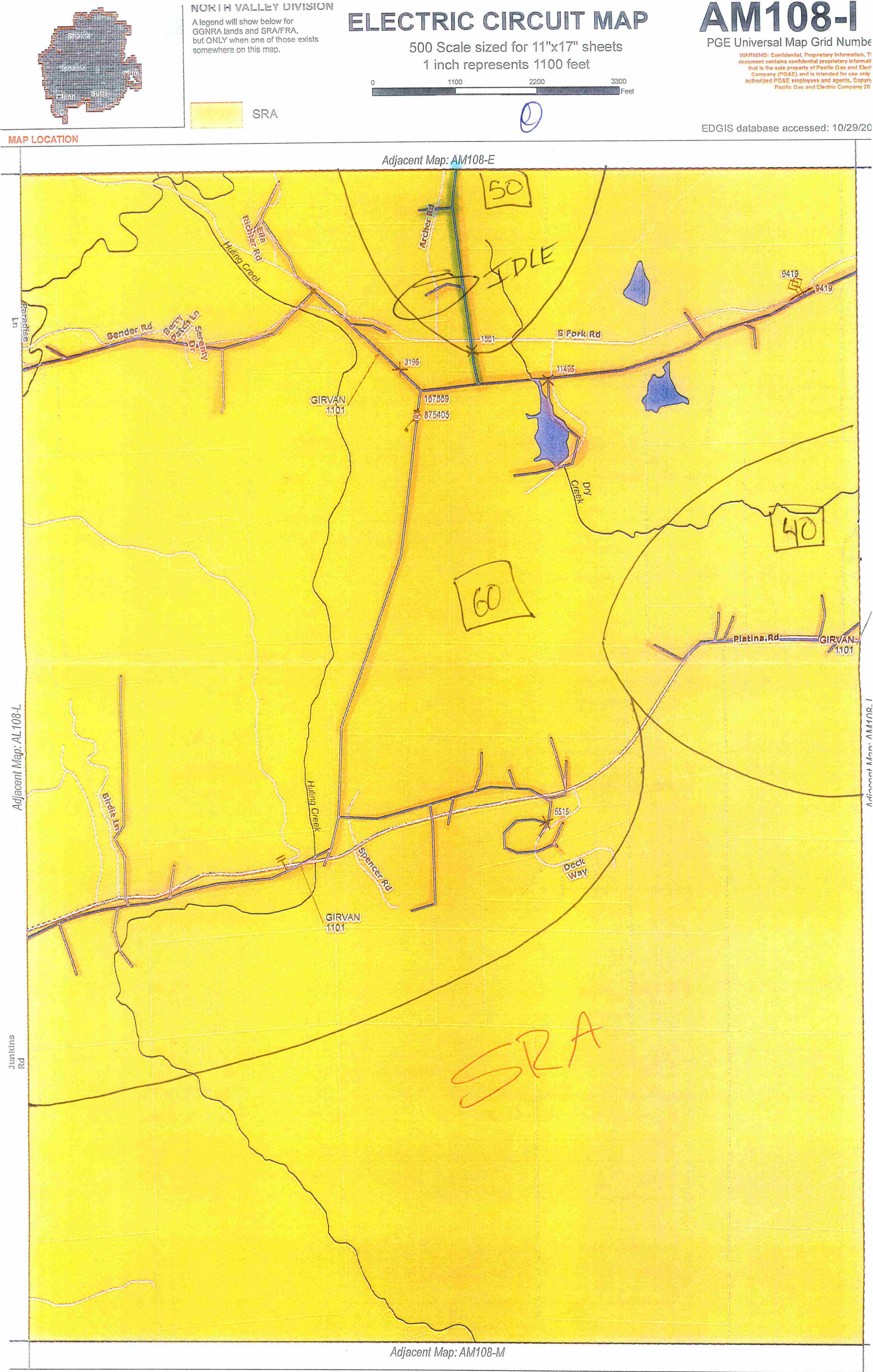



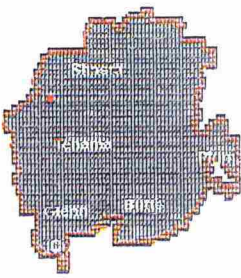

NORTH VALLEY DIVISION  
A legend will show below for GGNRA lands and SRA/FRA, but ONLY when one of those exists somewhere on this map.

FRA

SRA

ELECTRIC CIRCUIT MAP

500 Scale sized for 11"x17" sheets  
1 inch represents 1100 feet



AM108-E

PGE Universal Map Grid Number

WARNING: Confidential, Proprietary Information. This document contains confidential proprietary information that is the sole property of Pacific Gas and Electric Company (PG&E) and is intended for use only by authorized PG&E employees and agents. Copyright Pacific Gas and Electric Company 2015

MAP LOCATION

EDGIS database accessed: 10/29/201

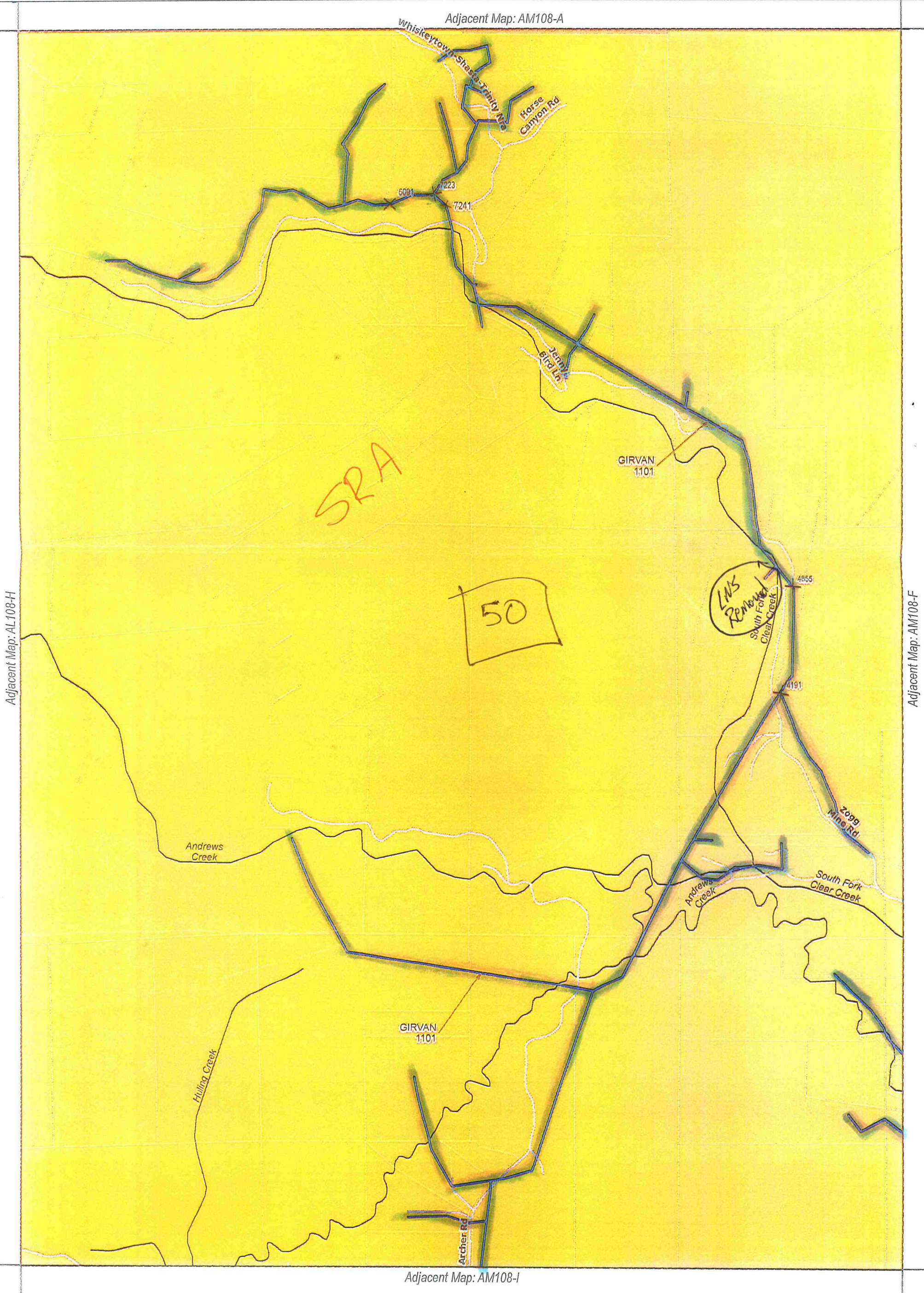

Adjacent Map: AL108-H

Adjacent Map: AM108-A

Adjacent Map: AM108-F

Adjacent Map: AM108-I



NORTH VALLEY DIVISION  
A legend will show below for  
GGNRA lands and SRA/FRA,  
but ONLY when one of those exists  
somewhere on this map.

FRA  
SRA

ELECTRIC CIRCUIT MAP

500 Scale sized for 11"x17" sheets  
1 inch represents 1100 feet



AM108-J

PGE Universal Map Grid Number

WARNING: Confidential, Proprietary Information. This document contains confidential proprietary information that is the sole property of Pacific Gas and Electric Company (PG&E) and is intended for use only by authorized PG&E employees and agents. Copyright Pacific Gas and Electric Company 2015.

EDGIS database accessed: 10/29/2016

MAP LOCATION

Adjacent Map: AM108-F

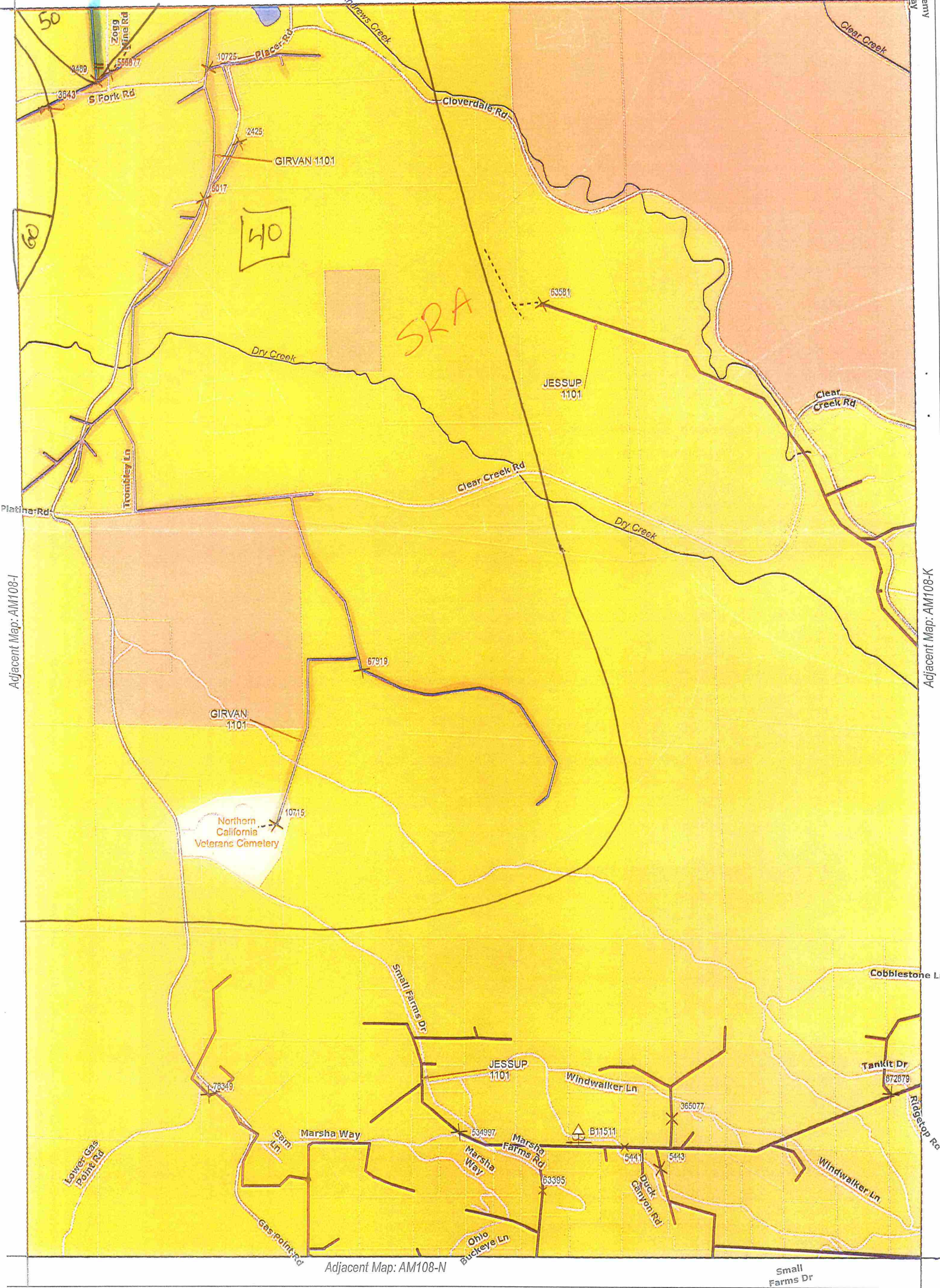



A legend will show below for GGNRA lands and SRA/FRA, but ONLY when one of those exists somewhere on this map.

FRA

SRA

1 inch represents 1100 feet



**WARNING: Confidential, Proprietary Information.** This document contains confidential proprietary information that is the sole property of Pacific Gas and Electric Company (PG&E) and is intended for use only by authorized PG&E employees and agents. Copyright Pacific Gas and Electric Company 2015.

### MAP LOCATION

Adjacent Map: AM108-B

527

40

Adjacent Map: AM108-J

Adjacent Map: AM108-G

Alchemy



Field Map

Girven 1101 Route 50

Zogg Mine



2018